

Items included in this section are in addition to standard Disclosure Plan requirements (as defined in the Land Sales Act 1984)

Where applicable,
Easements are shown as: [---]

NOTE:
This additional information is indicative only and has been taken from various sources and is a representation of the proposed infrastructure. The actual location should be checked on site after completion of construction.

The dimensions and locations of proposed easements may vary and are subject to final Council approval.

DISCLOSURE PLAN FOR PROPOSED LOT 24

This Disclosure Plan was prepared in accordance with the Land Sales Act 1984 to enable the sale of proposed lots. This plan should not be used for design purposes as the details shown on this plan may vary from final site conditions.

Retaining Walls are shown as: [---]

Area of Fill shown as: [shaded area]

Fill ranges in depth from 0.0m to 0.3m

Compaction of fill will be carried out in accordance with Australian Standard AS 3798-2007, with Level 1 certification.

Design surface contours based on A.H.D. datum at an interval of 0.5m, shown as: [---48.5---

Fill depth contours based on A.H.D. datum at an interval of 0.2m, shown as: [---0.2---

Areas and dimensions shown on this plan are subject to approval by Council and registration with the Department of Natural Resources and Mines, Manufacturing and Regional and Rural Development.

Design surface contours, fill contours, fill areas, depth of fill and retaining walls shown hereon have been plotted from data supplied by Burchills on 25/08/2025.

Project:

Fairwind
VICTORIA POINT

STAGE 4

Client:

**ORCHARD (BARCREST)
DEVELOPMENT PTY LTD**

LEVEL DATUM	AHD
LEVEL ORIGIN	PSM101367 RL14.667m
COMPUTER FILE	BRSS8434-006-15-1

MNG
LANDPARTNERS
Brisbane Office
Level 1
18 Little Cribb Street
Milton QLD 4064
p: (07) 3842 1000
e: brisbane@landpartners.com.au
w: www.landpartners.com.au
Perth | Brisbane | Melbourne | Sydney | Broome | South West WA

SCALE 1:200 (A3)

DRAWN WRD DATE 12/09/2025

CHECKED MEA DATE 17/09/2025

APPROVED RGA DATE 17/09/2025
UDN

BRSS8434-006 - 017 - 1



SCALE 1:200 (A3)

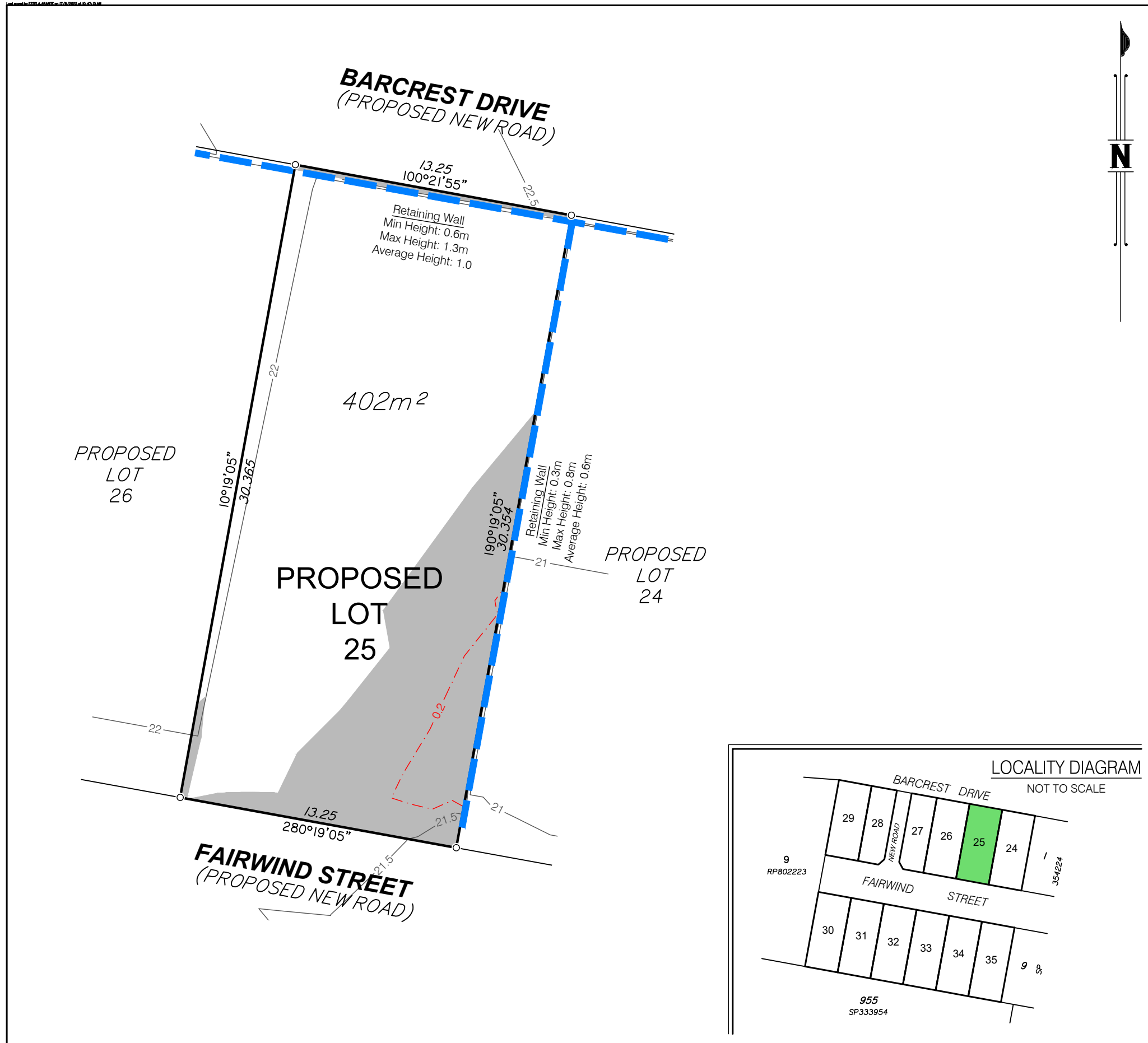

DISCLOSURE PLAN FOR PROPOSED LOT 25

This Disclosure Plan was prepared in accordance with the Land Sales Act 1984 to enable the sale of proposed lots. This plan should not be used for design purposes as the details shown on this plan may vary from final site conditions.

Retaining Walls are shown as:

Area of Fill shown as:

Fill ranges in depth from 0.0m to 0.3m.

Compaction of fill will be carried out in accordance with Australian Standard AS 3798-2007, with Level 1 certification.

Design surface contours based on A.H.D. datum at an interval of 0.5m, shown as: —48.5—

Fill depth contours based on A.H.D. datum at an interval of 0.2m, shown as: - - -0.2 - - -

Areas and dimensions shown on this plan are subject to approval by Council and registration with the Department of Natural Resources and Mines, Manufacturing and Regional and Rural Development.

Design surface contours, fill contours, fill areas, depth of fill and retaining walls shown hereon have been plotted from data supplied by Burchills on 25/08/2025.

Project:

Fairwind
VICTORIA POINT

STAGE 4

Client:

ORCHARD (BARCREST)
DEVELOPMENT PTY LTD

LEVEL DATUM	AHD
LEVEL ORIGIN	PSM101367 RL14.667m
COMPUTER FILE	BRSS8434-006-15-1

MNG
LANDPARTNERS

Brisbane Office
Level 1
18 Little Cribb Street
Milton QLD 4064
p: (07) 3842 1000
e: brisbane@landpartners.com.au
w: www.landpartners.com.au

Perth | Brisbane | Melbourne | Sydney | Broome | South West WA

SCALE		1:200 (A3)	
DRAWN	WRD	DATE	12/09/20
CHECKED	MEA	DATE	17/09/20



SCALE 1:200 (A3)

APPROVED	RGA	DATE	17/09/2025
UDN	BRSS8434-006 - 018 - 1		

Items included in this section are in addition to standard Disclosure Plan requirements (as defined in the Land Sales Act 1984)

Where applicable,
Easements are shown as: []

NOTE:
This additional information is indicative only and has been taken from various sources and is a representation of the proposed infrastructure. The actual location should be checked on site after completion of construction.

The dimensions and locations of proposed easements may vary and are subject to final Council approval.

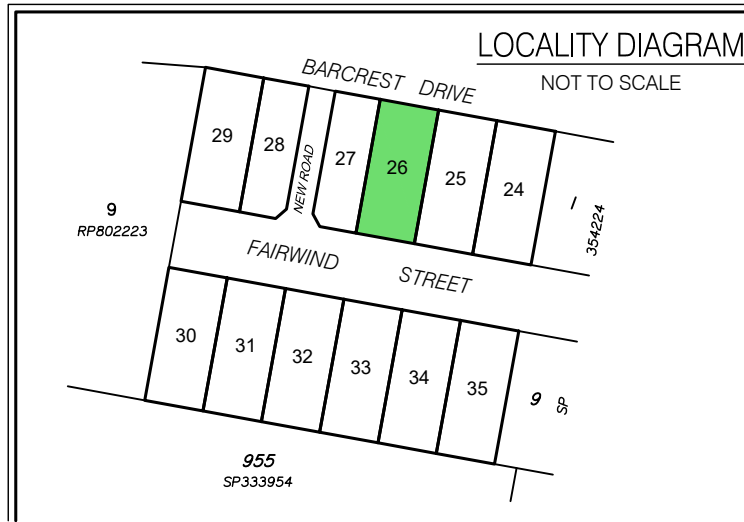
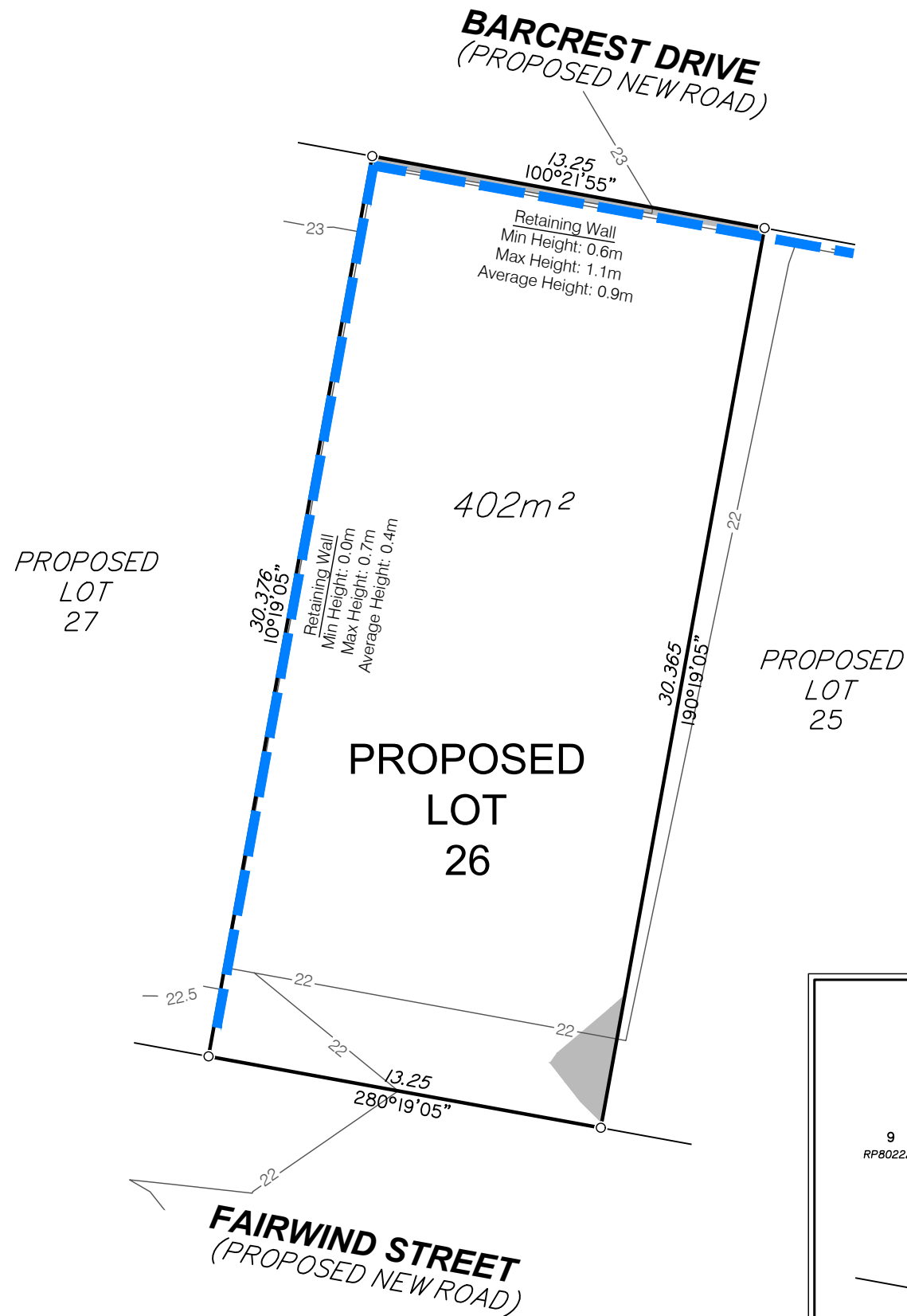

DISCLOSURE PLAN FOR PROPOSED LOT 26

This Disclosure Plan was prepared in accordance with the Land Sales Act 1984 to enable the sale of proposed lots. This plan should not be used for design purposes as the details shown on this plan may vary from final site conditions.

Retaining Walls are shown as:



Area of Fill shown as:



Fill ranges in depth from 0.0m to less than 0.1m

Compaction of fill will be carried out in accordance with Australian Standard AS 3798-2007, with Level 1 certification.

Design surface contours based on A.H.D. datum at an interval of 0.5m, shown as: —48.5—

Fill depth contours based on A.H.D. datum at an interval of 0.2m, shown as: - - -0.2 - - -

Areas and dimensions shown on this plan are subject to approval by Council and registration with the Department of Natural Resources and Mines, Manufacturing and Regional and Rural Development.

Design surface contours, fill contours, fill areas, depth of fill and retaining walls shown hereon have been plotted from data supplied by Burchills on 25/08/2025.

Project:

Fairwind
VICTORIA POINT

STAGE 4

Client:

**ORCHARD (BARCREST)
DEVELOPMENT PTY LTD**

LEVEL DATUM

AHD

LEVEL ORIGIN

PSM101367 RL14.667m

COMPUTER FILE

BRSS8434-006-15-1

SCALE

1:200 (A3)

DRAWN

WRD

DATE

12/09/2025

CHECKED

MEA

DATE

17/09/2025

APPROVED RGA

DATE

17/09/2025

UDN

BRSS8434-006 - 019 - 1

MNG
LANDPARTNERS

Brisbane Office
Level 1
18 Little Cribb Street
Milton QLD 4064

p: (07) 3842 1000
e: brisbane@landpartners.com.au
w: www.landpartners.com.au

Perth | Brisbane | Melbourne | Sydney | Broome | South West WA

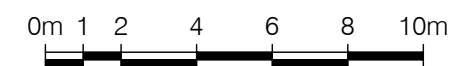

SCALE 1:200 (A3)

Items included in this section are in addition to standard Disclosure Plan requirements (as defined in the Land Sales Act 1984)

Where applicable,
Easements are shown as:

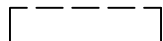

NOTE:

This additional information is indicative only and has been taken from various sources and is a representation of the proposed infrastructure. The actual location should be checked on site after completion of construction.

The dimensions and locations of proposed easements may vary and are subject to final Council approval.

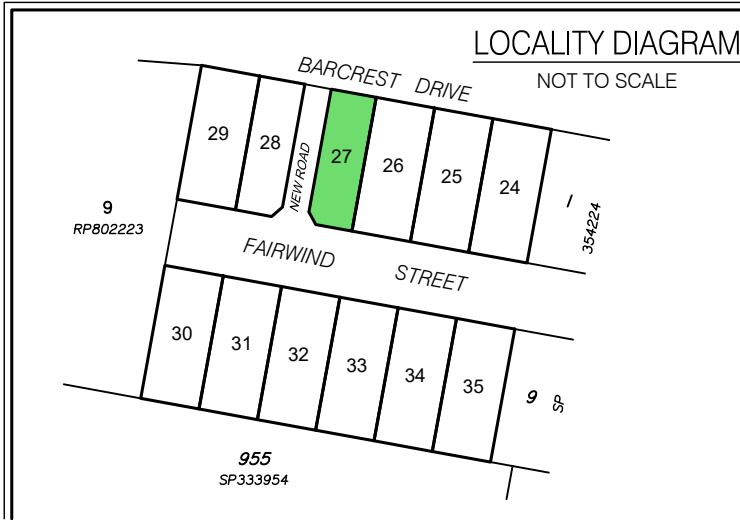

The dimensions and locations of proposed easements may vary and are subject to final Council approval.



SCALE 1:200 (A3)

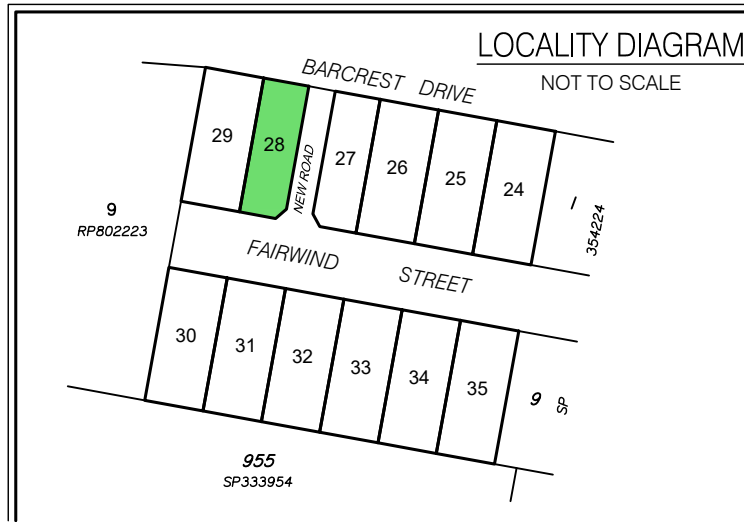
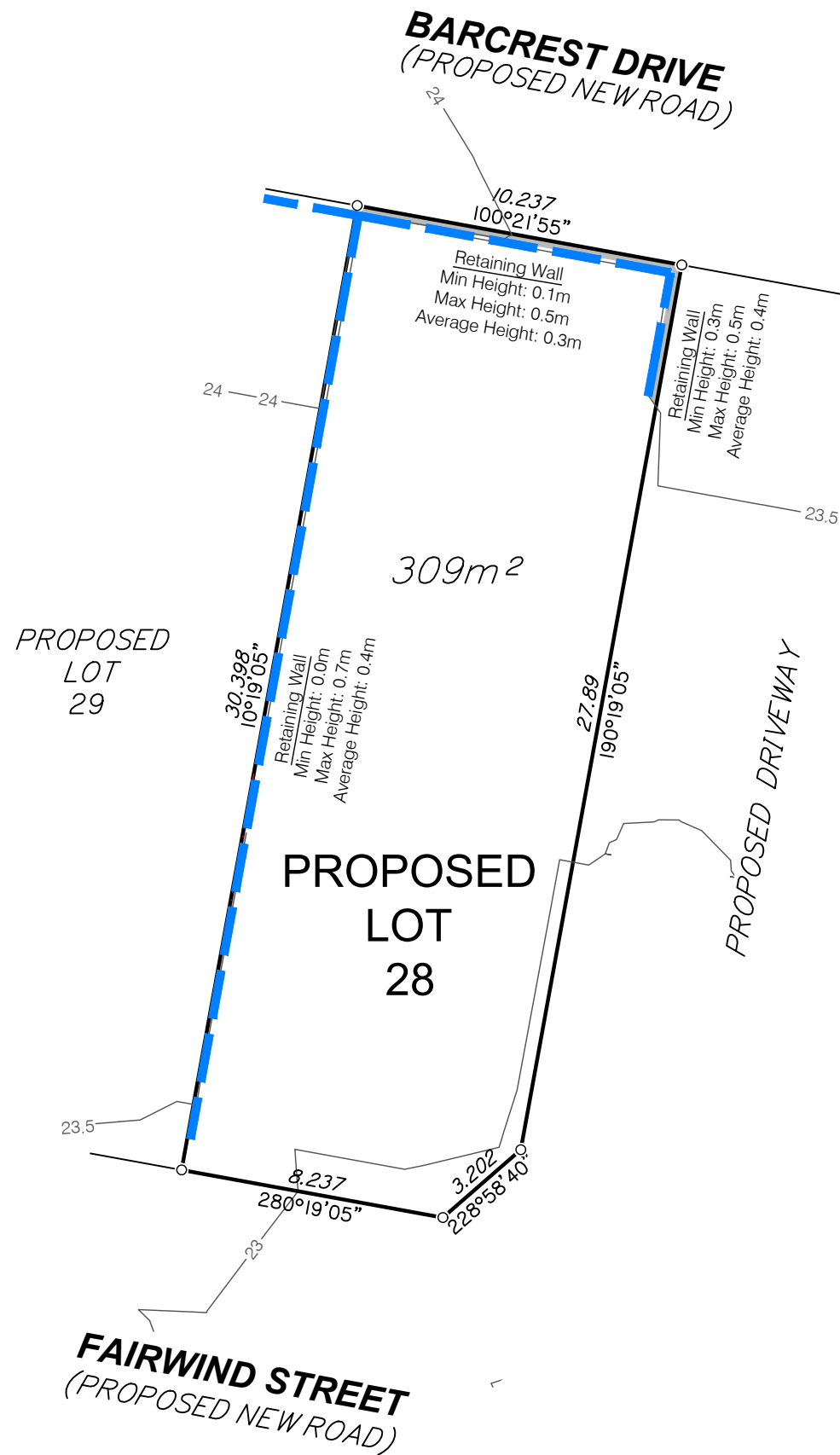

DISCLOSURE PLAN FOR PROPOSED LOT 28

This Disclosure Plan was prepared in accordance with the Land Sales Act 1984 to enable the sale of proposed lots. This plan should not be used for design purposes as the details shown on this plan may vary from final site conditions.

Retaining Walls are shown as:



Area of Fill shown as:



Fill ranges in depth from 0.0m to 0.2m.

Compaction of fill will be carried out in accordance with Australian Standard AS 3798-2007, with Level 1 certification.

Design surface contours based on A.H.D. datum at an interval of 0.5m, shown as: —48.5—

Fill depth contours based on A.H.D. datum at an interval of 0.2m, shown as: - - -0.2 - - -

Areas and dimensions shown on this plan are subject to approval by Council and registration with the Department of Natural Resources and Mines, Manufacturing and Regional and Rural Development.

Design surface contours, fill contours, fill areas, depth of fill and retaining walls shown hereon have been plotted from data supplied by Burchills on 01/10/2025.

Project:



STAGE 4

Client:

ORCHARD (BARCREST)
DEVELOPMENT PTY LTD

LEVEL DATUM	AHD
LEVEL ORIGIN	PSM101367 RL14.667m
COMPUTER FILE	BRSS8434-006-15-2



Brisbane Office
Level 1
18 Little Cribb Street
Milton QLD 4064

p: (07) 3842 1000
e: brisbane@landpartners.com.au
w: www.landpartners.com.au

Perth | Brisbane | Melbourne | Sydney | Broome | South West WA

SCALE 1:200 (A3)

DRAWN EAD DATE 07/10/2025

CHECKED MEA DATE 09/10/2025

APPROVED RGA DATE 09/10/2025

UDN

BRSS8434-006 - 021 - 2



SCALE 1:200 (A3)

Items included in this section are in addition to standard Disclosure Plan requirements (as defined in the Land Sales Act 1984)

Where applicable,
Easements are shown as:



NOTE:

This additional information is indicative only and has been taken from various sources and is a representation of the proposed infrastructure. The actual location should be checked on site after completion of construction.

The dimensions and locations of proposed easements may vary and are subject to final Council approval.

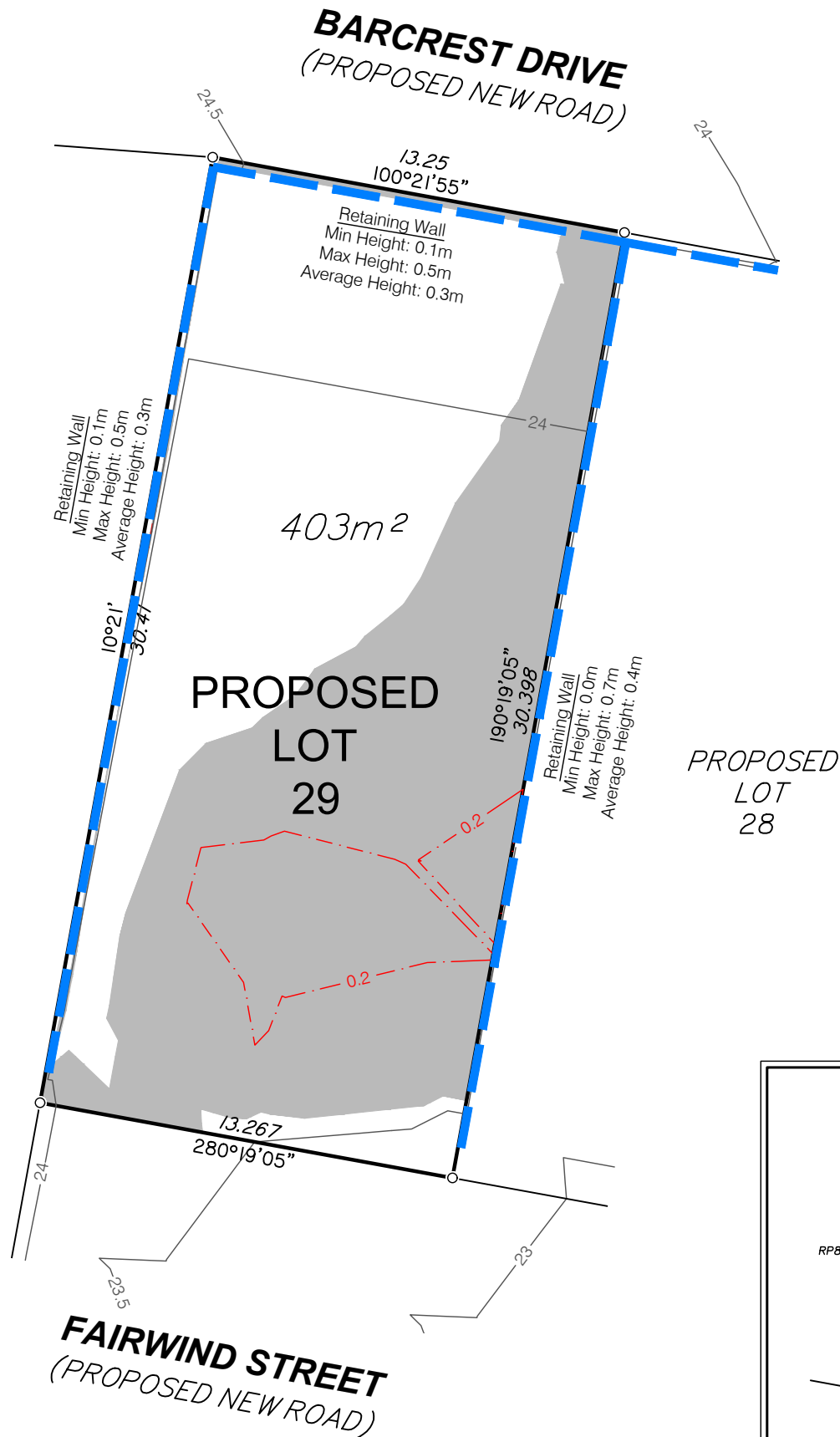

DISCLOSURE PLAN FOR PROPOSED LOT 29

This Disclosure Plan was prepared in accordance with the Land Sales Act 1984 to enable the sale of proposed lots. This plan should not be used for design purposes as the details shown on this plan may vary from final site conditions.

Retaining Walls are shown as:

Area of Fill shown as:

Fill ranges in depth from 0.0m to 0.2m.

Compaction of fill will be carried out in accordance with Australian Standard AS 3798-2007, with Level 1 certification.

Design surface contours based on A.H.D. datum at an interval of 0.5m, shown as: —48.5—

Fill depth contours based on A.H.D. datum at an interval of 0.2m, shown as: - - -0.2 - - -

Areas and dimensions shown on this plan are subject to approval by Council and registration with the Department of Natural Resources and Mines, Manufacturing and Regional and Rural Development.

Design surface contours, fill contours, fill areas, depth of fill and retaining walls shown hereon have been plotted from data supplied by Burchills on 01/10/2025.

Project:

Fairwind
VICTORIA POINT

STAGE 4

Client:

ORCHARD (BARCREST)
DEVELOPMENT PTY LTD

LEVEL DATUM

AHD

LEVEL ORIGIN

PSM101367 RL14.667m

COMPUTER FILE

BRSS8434-006-15-2

SCALE

1:200 (A3)

DRAWN

EAD

DATE

07/10/2025

CHECKED

MEA

DATE

09/10/2025

APPROVED

RGA

DATE

09/10/2025

UDN

BRSS8434-006 - 022 - 2

MNG
LANDPARTNERS

Brisbane Office
Level 1
18 Little Cribb Street
Milton QLD 4064

p: (07) 3842 1000
e: brisbane@landpartners.com.au
w: www.landpartners.com.au

Perth | Brisbane | Melbourne | Sydney | Broome | South West WA



SCALE 1:200 (A3)

Items included in this section are in addition to standard Disclosure Plan requirements (as defined in the Land Sales Act 1984)

Where applicable,
Easements are shown as:



NOTE:

This additional information is indicative only and has been taken from various sources and is a representation of the proposed infrastructure. The actual location should be checked on site after completion of construction.

The dimensions and locations of proposed easements may vary and are subject to final Council approval.

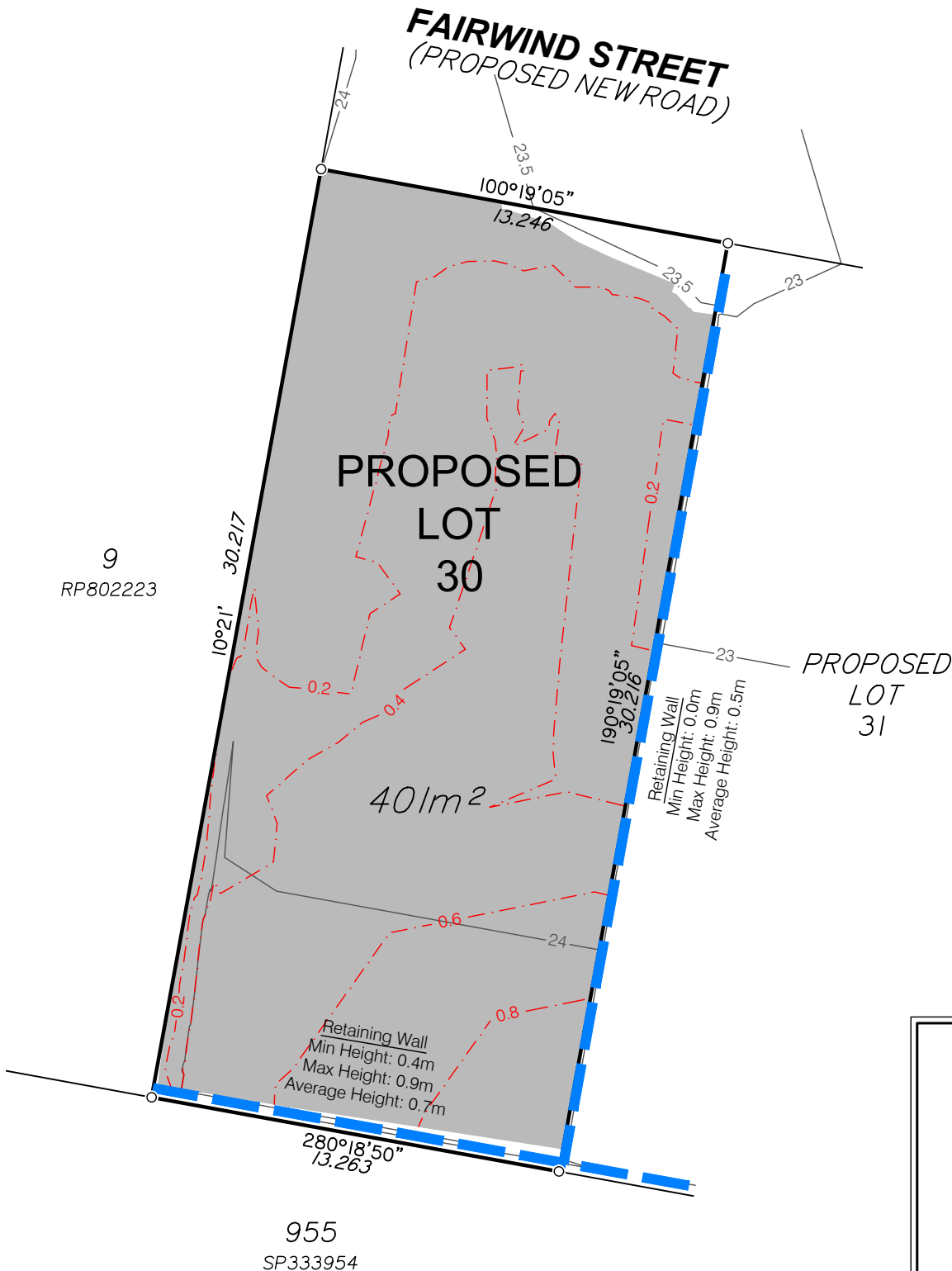

Items included in this section are in addition to standard Disclosure Plan requirements (as defined in the Land Sales Act 1984)

Where applicable,
Easements are shown as: []

NOTE:
This additional information is indicative only and has been taken from various sources and is a representation of the proposed infrastructure. The actual location should be checked on site after completion of construction.

The dimensions and locations of proposed easements may vary and are subject to final Council approval.

DISCLOSURE PLAN FOR PROPOSED LOT 30

This Disclosure Plan was prepared in accordance with the Land Sales Act 1984 to enable the sale of proposed lots. This plan should not be used for design purposes as the details shown on this plan may vary from final site conditions.

Retaining Walls are shown as: []

Area of Fill shown as: []

Fill ranges in depth from 0.0m to 0.9m.

Compaction of fill will be carried out in accordance with Australian Standard AS 3798-2007, with Level 1 certification.

Design surface contours based on A.H.D. datum at an interval of 0.5m, shown as: []

Fill depth contours based on A.H.D. datum at an interval of 0.2m, shown as: []

Areas and dimensions shown on this plan are subject to approval by Council and registration with the Department of Natural Resources and Mines, Manufacturing and Regional and Rural Development.

Design surface contours, fill contours, fill areas, depth of fill and retaining walls shown hereon have been plotted from data supplied by Burchills on 25/08/2025.

Project:

Fairwind
VICTORIA POINT

STAGE 4

Client:

**ORCHARD (BARCREST)
DEVELOPMENT PTY LTD**

LEVEL DATUM AHD

LEVEL ORIGIN PSM101367 RL14.667m

COMPUTER FILE BRSS8434-006-15-1

SCALE 1:200 (A3)

DRAWN WRD DATE 12/09/2025

CHECKED MEA DATE 17/09/2025

APPROVED RGA DATE 17/09/2025

UDN

BRSS8434-006 - 023 - 1

MNG
LANDPARTNERS
Brisbane Office
Level 1
18 Little Cribb Street
Milton QLD 4064
p: (07) 3842 1000
e: brisbane@landpartners.com.au
w: www.landpartners.com.au

Perth | Brisbane | Melbourne | Sydney | Broome | South West WA



SCALE 1:200 (A3)

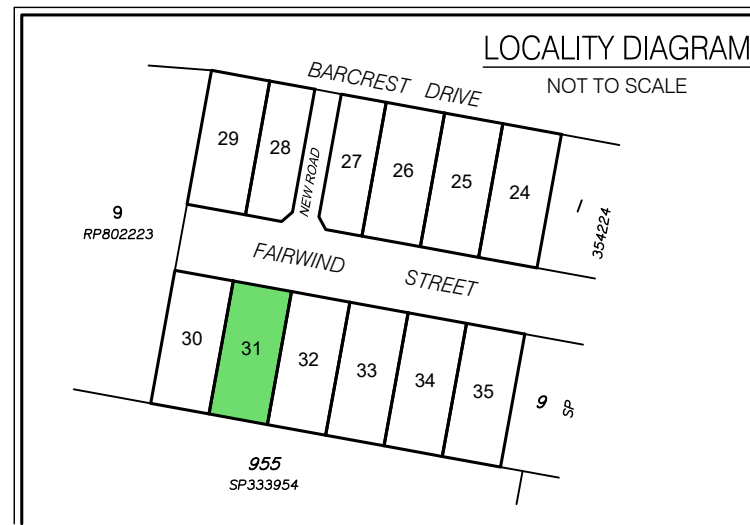
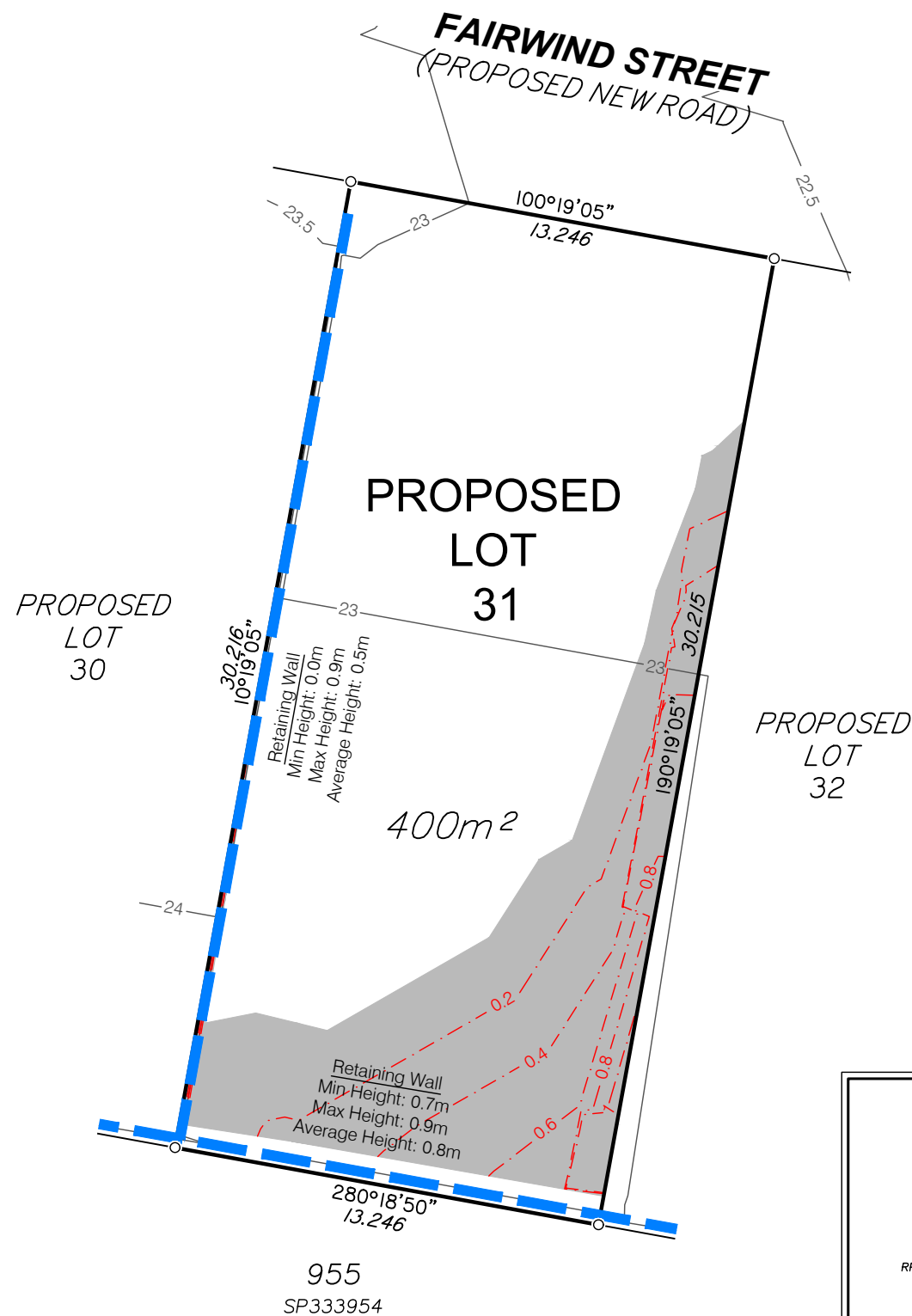

DISCLOSURE PLAN FOR PROPOSED LOT 31

This Disclosure Plan was prepared in accordance with the Land Sales Act 1984 to enable the sale of proposed lots. This plan should not be used for design purposes as the details shown on this plan may vary from final site conditions.

Retaining Walls are shown as:

Area of Fill shown as:

Fill ranges in depth from 0.0m to 1.1m.

Compaction of fill will be carried out in accordance with Australian Standard AS 3798-2007, with Level 1 certification.

Design surface contours based on A.H.D. datum at an interval of 0.5m, shown as: —48.5—

Fill depth contours based on A.H.D. datum at an interval of 0.2m, shown as: - - -0.2 - - -

Areas and dimensions shown on this plan are subject to approval by Council and registration with the Department of Natural Resources and Mines, Manufacturing and Regional and Rural Development.

Design surface contours, fill contours, fill areas, depth of fill and retaining walls shown hereon have been plotted from data supplied by Burchills on 25/08/2025.

Project:

Fairwind
VICTORIA POINT

STAGE 4

Client:

ORCHARD (BARCREST)
DEVELOPMENT PTY LTD

LEVEL DATUM

AHD

LEVEL ORIGIN

PSM101367 RL14.667m

COMPUTER FILE

BRSS8434-006-15-1

SCALE

1:200 (A3)

DRAWN

WRD

DATE 12/09/2025

CHECKED

MEA

DATE 17/09/2025

APPROVED RGA

DATE 17/09/2025

UDN

BRSS8434-006 - 024 - 1

MNG
LANDPARTNERS

Brisbane Office
Level 1
18 Little Cribb Street
Milton QLD 4064

p: (07) 3842 1000
e: brisbane@landpartners.com.au
w: www.landpartners.com.au

Perth | Brisbane | Melbourne | Sydney | Broome | South West WA

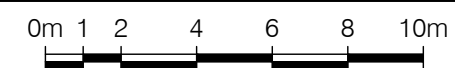

SCALE 1:200 (A3)

Items included in this section are in addition to standard Disclosure Plan requirements (as defined in the Land Sales Act 1984)

Where applicable,
Easements are shown as:

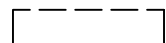

NOTE:

This additional information is indicative only and has been taken from various sources and is a representation of the proposed infrastructure. The actual location should be checked on site after completion of construction.

The dimensions and locations of proposed easements may vary and are subject to final Council approval.



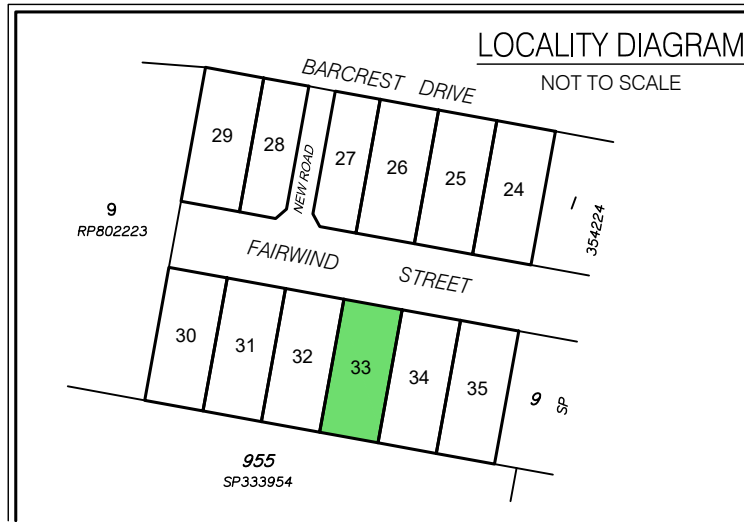
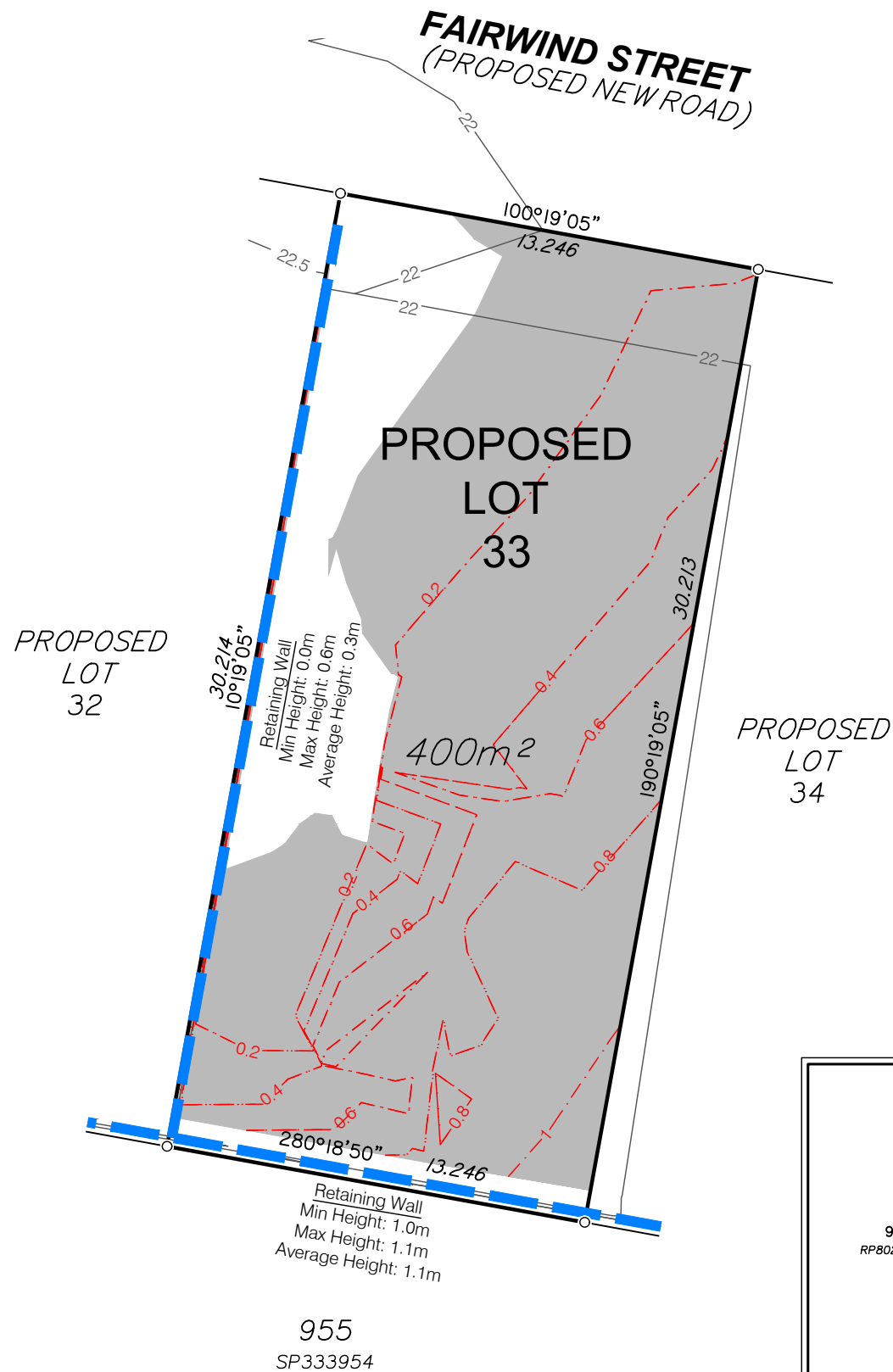

DISCLOSURE PLAN FOR PROPOSED LOT 33

This Disclosure Plan was prepared in accordance with the Land Sales Act 1984 to enable the sale of proposed lots. This plan should not be used for design purposes as the details shown on this plan may vary from final site conditions.

Retaining Walls are shown as:



Area of Fill shown as:



Fill ranges in depth from 0.0m to 1.1m.

Compaction of fill will be carried out in accordance with Australian Standard AS 3798-2007, with Level 1 certification.

Design surface contours based on A.H.D. datum at an interval of 0.5m, shown as: —48.5—

Fill depth contours based on A.H.D. datum at an interval of 0.2m, shown as: - - -0.2 - - -

Areas and dimensions shown on this plan are subject to approval by Council and registration with the Department of Natural Resources and Mines, Manufacturing and Regional and Rural Development.

Design surface contours, fill contours, fill areas, depth of fill and retaining walls shown hereon have been plotted from data supplied by Burchills on 25/08/2025.

Project:



STAGE 4

Client:

ORCHARD (BARCREST)
DEVELOPMENT PTY LTD

LEVEL DATUM	AHD
LEVEL ORIGIN	PSM101367 RL14.667m
COMPUTER FILE	BRSS8434-006-15-1

Brisbane Office
 Level 1
 18 Little Cribb Street
 Milton QLD 4064
 p: (07) 3842 1000
 e: brisbane@landpartners.com.au
 w: www.landpartners.com.au

Perth | Brisbane | Melbourne | Sydney | Broome | South West WA

SCALE		1:200 (A3)	
DRAWN	WRD	DATE	12/09/2025
CHECKED	MEA	DATE	17/09/2025



SCALE 1:200 (A3)

APPROVED	RGA	DATE	17/09/2025
UDN	BRSS8434-006 - 026 - 1		

Items included in this section are in addition to standard Disclosure Plan requirements (as defined in the Land Sales Act 1984)

Where applicable,
Easements are shown as: [] [] [] []

NOTE:
This additional information is indicative only and has been taken from various sources and is a representation of the proposed infrastructure. The actual location should be checked on site after completion of construction.

The dimensions and locations of proposed easements may vary and are subject to final Council approval.

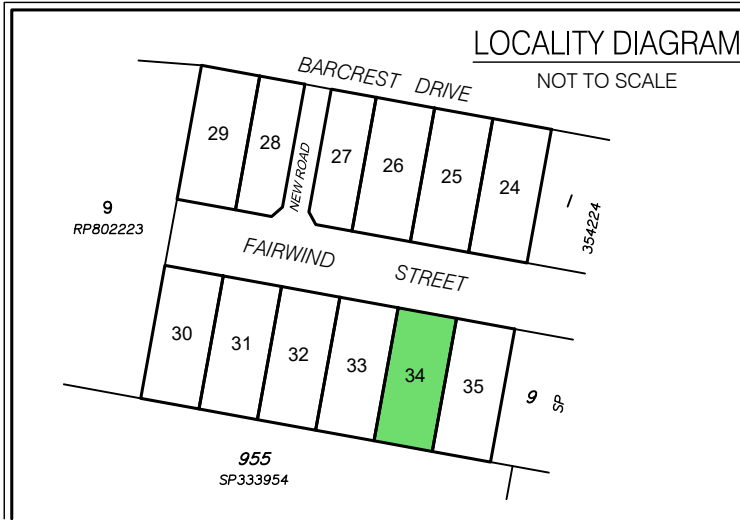
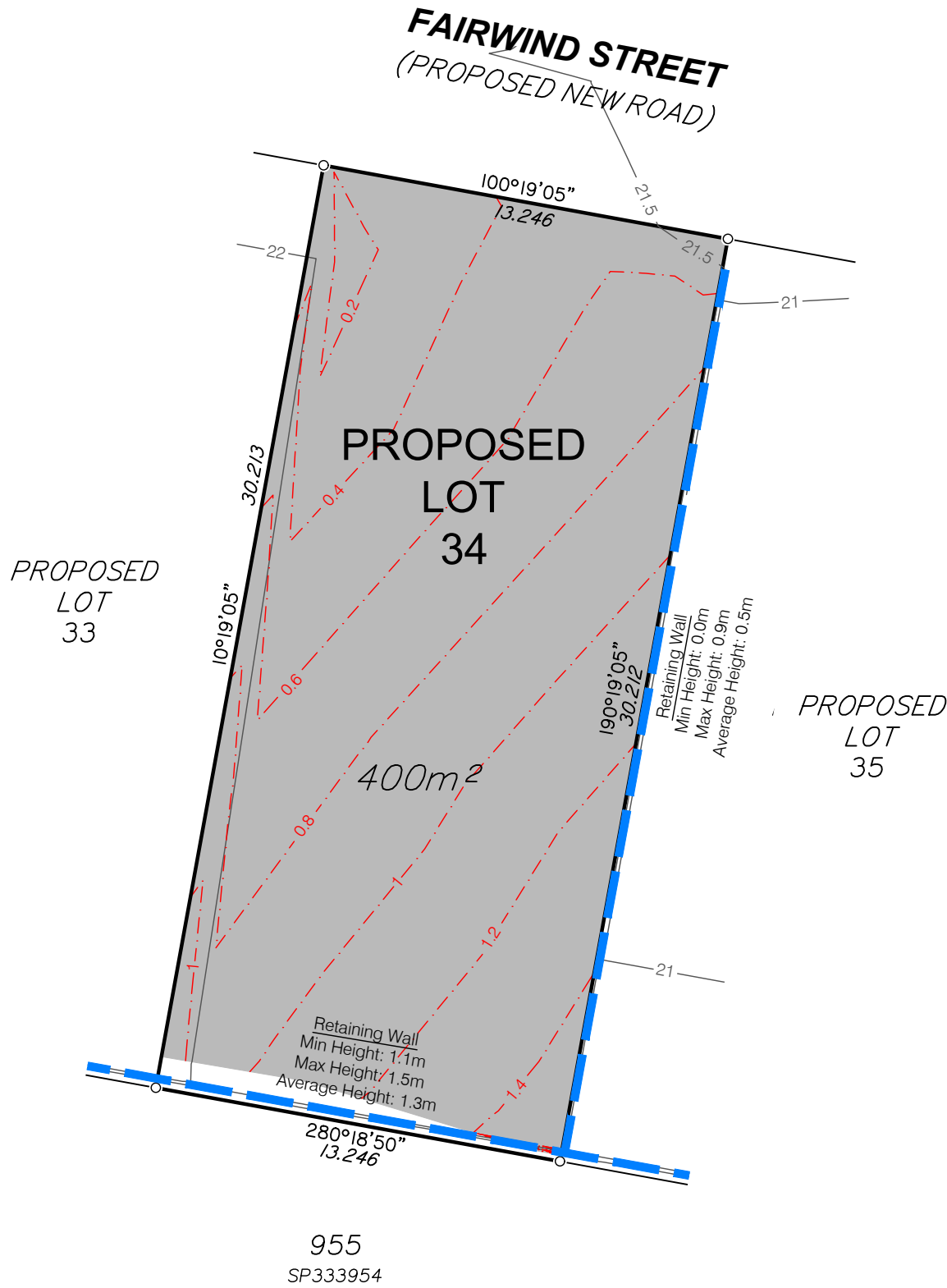

DISCLOSURE PLAN FOR PROPOSED LOT 34

This Disclosure Plan was prepared in accordance with the Land Sales Act 1984 to enable the sale of proposed lots. This plan should not be used for design purposes as the details shown on this plan may vary from final site conditions.

Retaining Walls are shown as:

Area of Fill shown as:

Fill ranges in depth from 0.2m to 1.5m.

Compaction of fill will be carried out in accordance with Australian Standard AS 3798-2007, with Level 1 certification.

Design surface contours based on A.H.D. datum at an interval of 0.5m, shown as: —48.5—

Fill depth contours based on A.H.D. datum at an interval of 0.2m, shown as: - - -0.2 - - -

Areas and dimensions shown on this plan are subject to approval by Council and registration with the Department of Natural Resources and Mines, Manufacturing and Regional and Rural Development.

Design surface contours, fill contours, fill areas, depth of fill and retaining walls shown hereon have been plotted from data supplied by Burchills on 01/10/2025.

Project:

Fairwind
VICTORIA POINT

STAGE 4

Client:

ORCHARD (BARCREST)
DEVELOPMENT PTY LTD

LEVEL DATUM

AHD

LEVEL ORIGIN

PSM101367 RL14.667m

COMPUTER FILE

BRSS8434-006-15-2

SCALE

1:200 (A3)

DRAWN

EAD

DATE

07/10/2025

CHECKED

MEA

DATE

09/10/2025

APPROVED

RGA

DATE

09/10/2025

UDN

BRSS8434-006 - 027 - 2

MNG
LANDPARTNERS

Brisbane Office
Level 1
18 Little Cribb Street
Milton QLD 4064

p: (07) 3842 1000
e: brisbane@landpartners.com.au
w: www.landpartners.com.au

Perth | Brisbane | Melbourne | Sydney | Broome | South West WA



SCALE 1:200 (A3)

Items included in this section are in addition to standard Disclosure Plan requirements (as defined in the Land Sales Act 1984)

Where applicable,
Easements are shown as:



NOTE:

This additional information is indicative only and has been taken from various sources and is a representation of the proposed infrastructure. The actual location should be checked on site after completion of construction.

The dimensions and locations of proposed easements may vary and are subject to final Council approval.

